

Box: PLOCK 1

BIKE	SUZUKI GSXR 600 / 750 K6	PART NO.	ESI - 86
YEAR	2006 - 2007	FIT KITS	OVAL Z039.11051
NOTES		FEATURES	DB KILLER Z038.10120

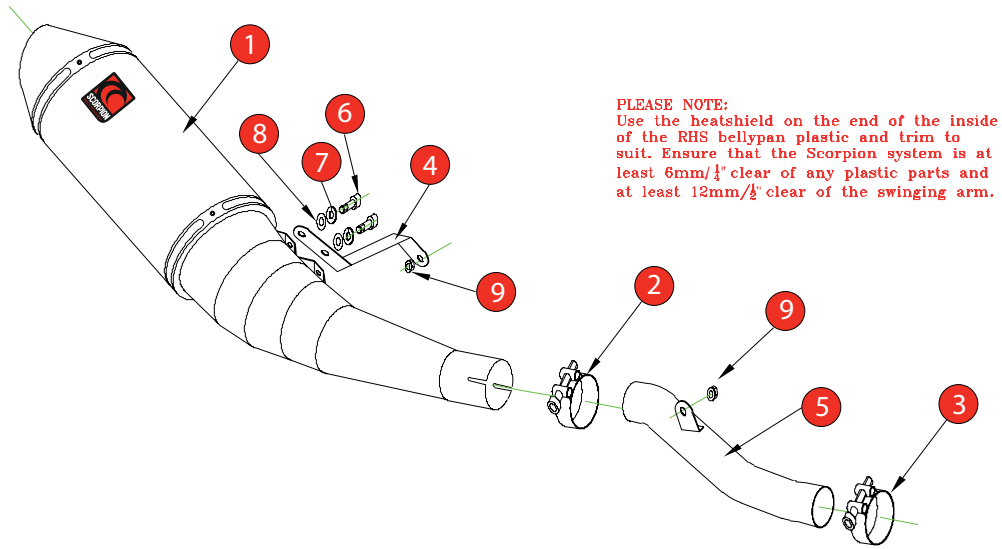

**PLEASE NOTE:**  
Use the heatshield on the end of the inside of the RHS bellypan plastic and trim to suit. Ensure that the Scorpion system is at least 6mm/¼" clear of any plastic parts and at least 12mm/½" clear of the swinging arm.

- |   |   |
|---|---|
| 1 200mm Tagma Silencer ESC 73               | 8 2 x M8 x 17mm Washers (Z017.10831)      |
| 2 55-59mm Band Clamp (Z016.10004)           | 9 2 x M8 Nyloc Nuts (Z017.10062)          |
| 3 47-51mm Band Clamp (Z016.10003)           | 10 100mm x 100mm Adhesive Thin Heatshield |
| 4 Mounting Bracket (Z015.10885)             |   |
| 5 Connecting Pipe CP 361                    |   |
| 6 2 x M8 x 12mm cap head bolts (Z017.10070) |   |
| 7 2 x M8 Spring Washers (z017.10064)        |   |

E-MARK ROUND	N/A
E-MARK OVAL	e4 2210
ISSUE NO.	9
DATE	22/08/08
AUTHORISED	S.Northrop
CHECKED	

**NOTE:** ENSURE SCORPION SYSTEM IS CLEAR OF MOVING PARTS AND ALL ORIGINAL FUNCTIONS WORK CORRECTLY.



- A) Remove original exhaust from bike, taking care to keep all original components in a safe place.
- B) Refit Scorpion exhaust as per line diagram above.
- C) When fitted take bike for a short ride to ensure all functions are correct.
- D) When bike & exhaust are cool enough check all nuts and bolts are still secure.

