

BIKE	KAWASKI Z1000	PART NO.	RKA-87
YEAR	2010 - ON	FIT KITS	Z039.20406
NOTES	Large landscape badge Z016.10110 to be used. OE gaskets must be removed prior to fitting of Scorpion connecting pipes items 2 & 3.	FEATURES	DB KILLER Z038.10043

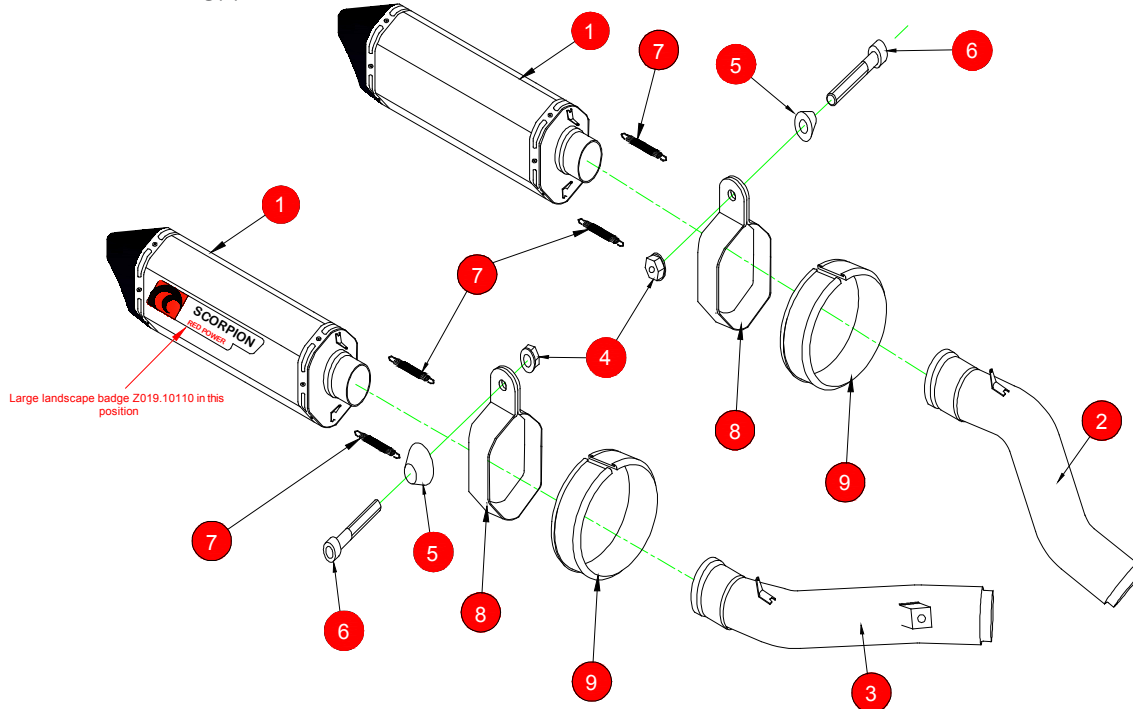

- | | |
|---|---|
| 1 RSC-184, 2 x 300mm Serket Silencers | 8 2 x Silencer Straps (Z028.20137) |
| 2 L/H Connecting Pipe CP623 | 9 2 x Strap Rubbers 375mm long (Z029.10022) |
| 3 R/H Connecting Pipe CP624 | 10 47-51mm Band Clamp (Z016.10003) |
| 4 2 x M8 Nyloc Nuts (Z017.10062) | |
| 5 2 x Alloy Bolt Finishers (Z026.20068) | |
| 6 2 x M8x60mm Cap Head Bolts (Z017.10080) | |
| 7 4 x Rubber Coated Springs (Z028.10030) | |

E-MARK	KA-86 e4 2374 9
ISSUE NO.	2
DATE	15/07/11
AUTHORISED	S.PEPPER
CHECKED	

NOTE: ENSURE SCORPION SYSTEM IS CLEAR OF MOVING PARTS AND ALL ORIGINAL FUNCTIONS WORK CORRECTLY.

Fitting Instructions Overleaf:



Box: PLOCK 2

BIKE	KAWASAKI Z1000	PART NO.	RKA-87
YEAR	2010 - on	FIT KITS	Z039.20406
NOTES	Large landscape badge Z016.10110 to be used. OE gaskets must be removed prior to fitting of Scorpion connecting pipes items 2 & 3.	FEATURES	DB KILLER Z038.10043

CONTINUED FROM OVERLEAF:



A) Disconnect cables on exhaust valve and leave loose..

B) To disconnect cables at the servo box end, you have to remove the hexagonal wheel, without turning it's shaft.
Remove bolt in centre of hexagonal wheel using an 8mm socket. Support wheel if tight.

C) Remove hexagonal wheel from shaft, retaining OE bolt. DO NOT turn shaft.

Remove spring clip retaining cables and completely remove the cables



D) The replacement wheel comes with an aluminium collar & spring washer that is secured in place with OE bolt – TIGHTEN TO 5ft/lb USING A TORQUE WRENCH..



The replacement wheel must be fitted with the etched letters "UP"

E IS RIGHT!
F IS WRONG!